

Los Angeles

CONVENTION CENTER

Managed By  ASM
GLOBAL



FLOORPLANS AND SPECIFICATIONS

EXHIBIT HALLS - LEVEL ONE

Level One - Exhibit Space

- Exhibit Space
- Pre-function/Registration
- Show Offices
- Restaurant/Concessions
- Business Service Center
- FD Freight Door
- FE Freight Elevator
- PE Passenger Elevator
- M Men's Restroom
- W Women's Restroom
- AG All Gender Restroom
- E Escalator
- G Groundwork Coffee & Concessions
- A ATM
- Column
- First Aid/Lactation Room

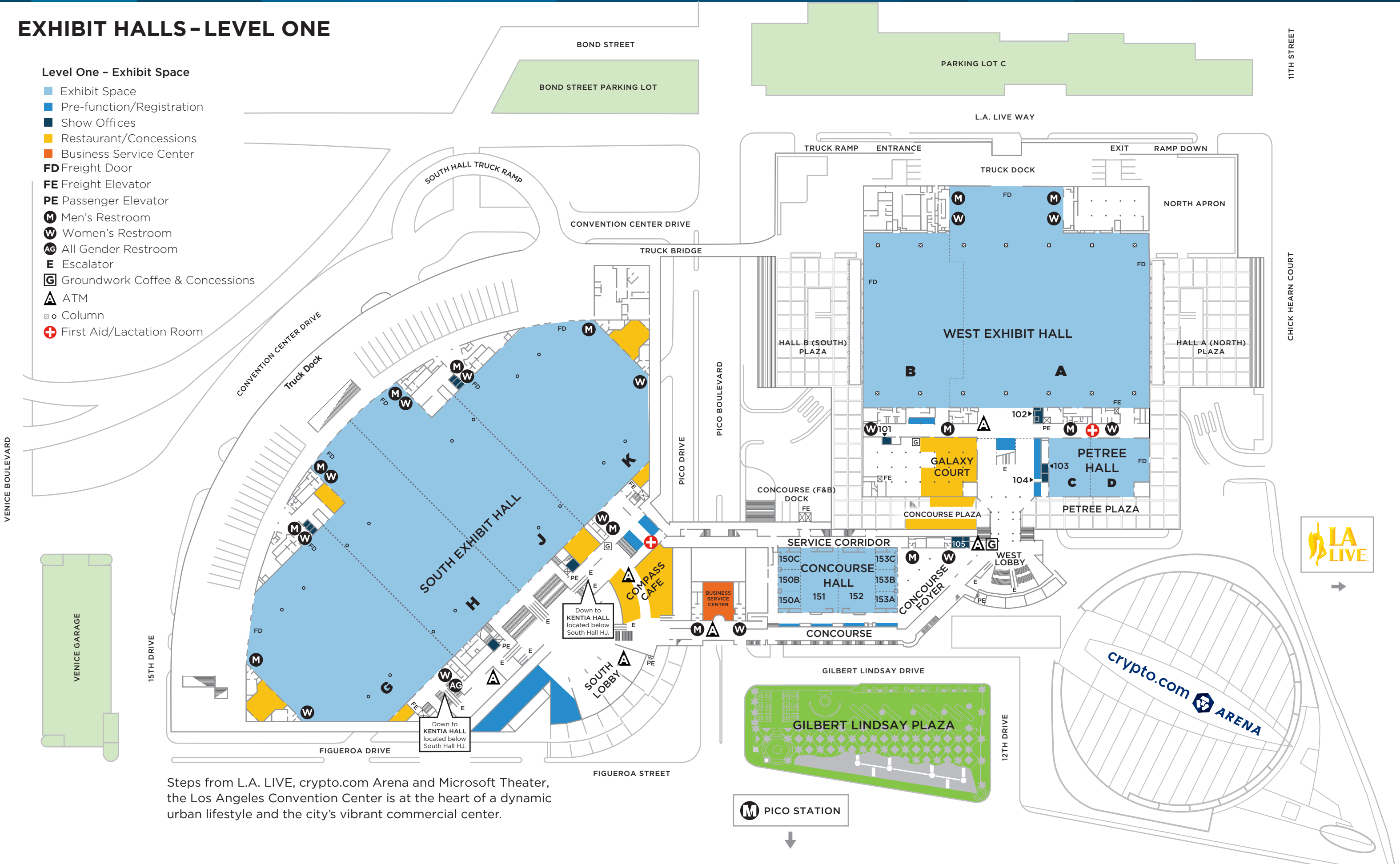

Steps from L.A. LIVE, crypto.com Arena and Microsoft Theater, the Los Angeles Convention Center is at the heart of a dynamic urban lifestyle and the city's vibrant commercial center.

M PICO STATION

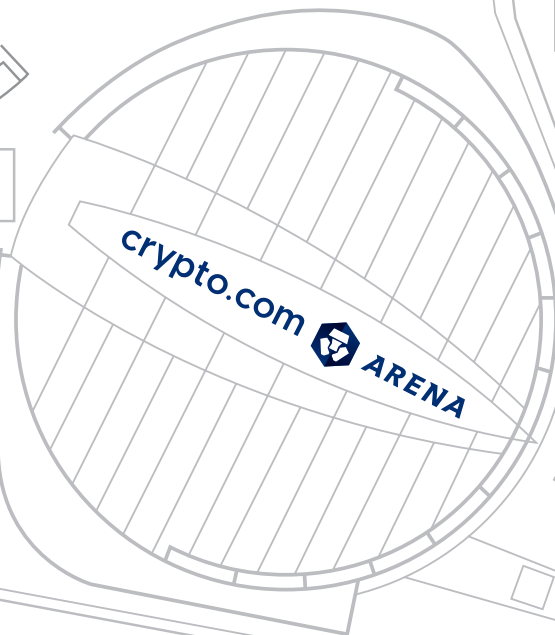

KENTIA HALL - LOWER LEVEL

Lower Level - Exhibit Space

- Exhibit Space
- Pre-function/Registration
- Show Offices
- Restaurant/Concessions
- FD Freight Door
- FE Freight Elevator
- PE Passenger Elevator
- M Men's Restroom
- W Women's Restroom
- E Escalator
- Column

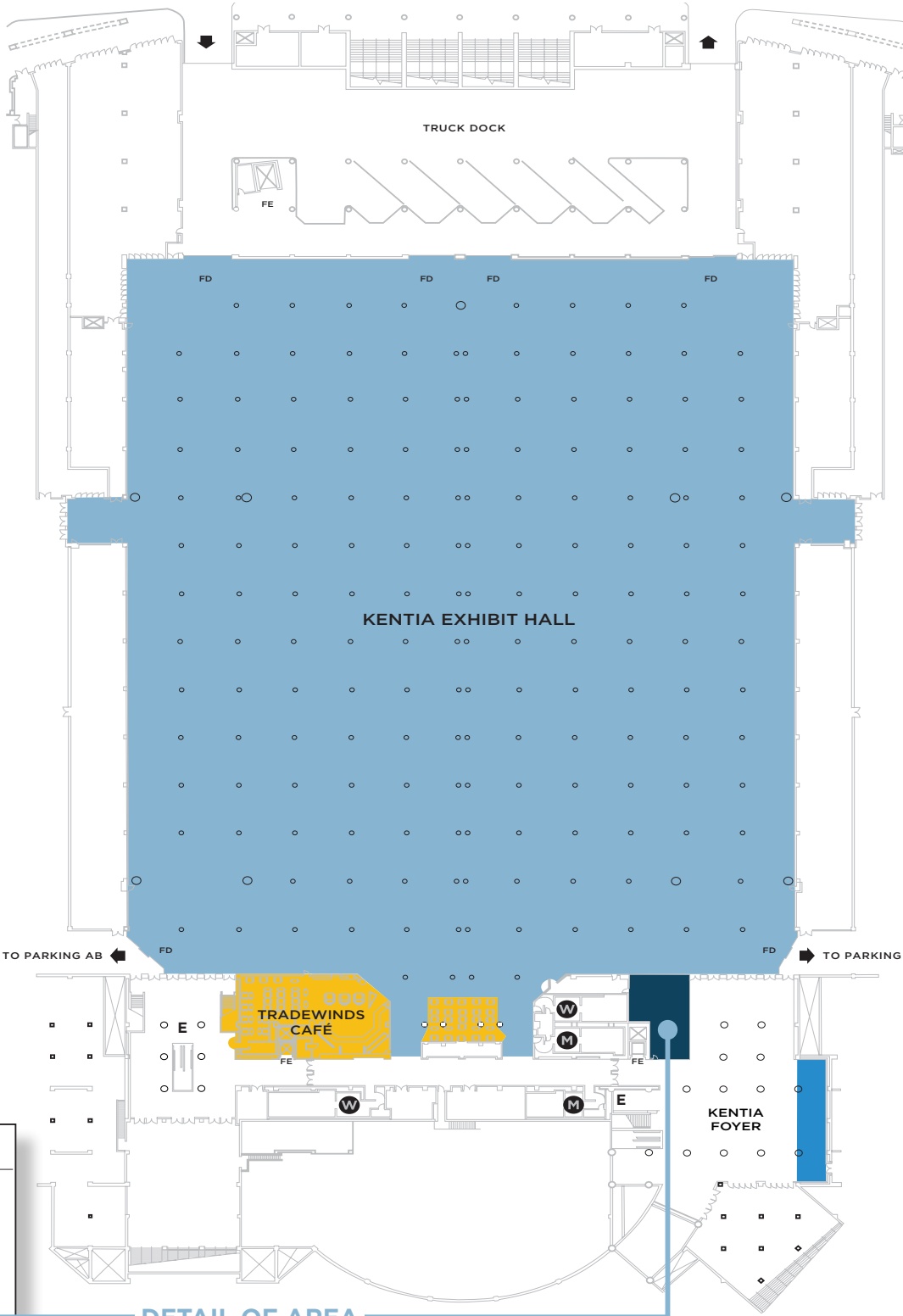

EXHIBIT HALLS-LEVEL ONE & LOWER LEVEL

Maximum Capacity*							
West Hall	DIMENSIONS	SQUARE FEET	CEILING HEIGHT	10'X10'	THEATRE	CLASSROOM ^(a)	BANQUET ^(b)
A	342 x 363	147,506	36'***	715	10,000	‡	7,500
B	342 x 194	63,619	36'***	300	5,000	‡	2,500
AB combined	342 x 557	210,685	36'***	1,050	15,000	‡	10,000
Petree Hall	DIMENSIONS	SQUARE FEET	CEILING HEIGHT	10'X10'	THEATRE	CLASSROOM ^(a)	BANQUET ^(b)
C	83 x 114	9,462	17'***	45	1,010	500	470
D	111 x 114	11,926	17'***	60	1,200	600	500
CD combined	194 x 112	21,557	17'***	115	2,000	1,000	1,000
Concourse Hall	DIMENSIONS	SQUARE FEET	CEILING HEIGHT	10'X10'	THEATRE	CLASSROOM ^(a)	BANQUET ^(b)
150A or C, 153A or C	40 x 33	1,320	17'	‡	100	50	50
150B or 153B	40 x 42	1,680	17'	‡	140	100	60
150AB or BC, 153AB or BC	40 x 75	3,000	17'	‡	300	120	110
150ABC or 153ABC	40 x 109	4,360	17'	‡	360	220	180
151 or 152	74 x 117	8,658	17'	40	1,020	590	440
150 & 151 (Concourse E)	115 x 109/117	13,123	17'	65	1,500	830	675
151 & 152	148 x 117	17,316	17'	100	1,800	1,000	900
152 & 153 (Concourse F)	115 x 109/117	13,123	17'	65	1,500	830	675
150, 151, 152, 153 combined	230 x 109/117	26,342	17'	135	2,700	1,500	1,400
South Hall	DIMENSIONS	SQUARE FEET	CEILING HEIGHT	10'X10'	THEATRE	CLASSROOM ^(a)	BANQUET ^(b)
G	300 x 360	96,660	40'	490	6,300	‡	3,620
H	180 x 360/460	76,785	40'	420	‡	‡	‡
J	180 x 360/460	76,785	40'	420	‡	‡	‡
K	300 x 360	96,660	40'	490	6,300	‡	3,620
GH combined	480 x 360/460	173,445	40'	880	11,400	‡	6,400
HJ combined	360 x 360/460	153,570	40'	840	10,000	‡	5,400
JK combined	480 x 360/460	173,445	40'	880	11,400	‡	6,400
GHJ/HJK combined	600 x 360/460	250,230	40'	1,371	16,555	‡	8,000
GHJK combined	940 x 360/460	346,890	40'	1,720	22,870	‡	12,800
Kentia Hall	DIMENSIONS	SQUARE FEET	CEILING HEIGHT	NUMBER OF BOOTHS		BANQUET ^(b)	
Ketia Hall (Located below HJ)	360' x 460'	162,000	18' min	844 (10' x 10') + 64 (8' x 10')		5,000	

* Capacities subject to change based on staging and audio-visual.
‡ Custom capacity based on Fire Marshal approval
(a) Classroom set based on four (4) per 8'x18" table
(b) Banquet set based on ten (10) per 66" round table.

** 25' Soffit
*** 15' Soffit



MEETING ROOMS (300,400, 500 SERIES) -LEVEL TWO

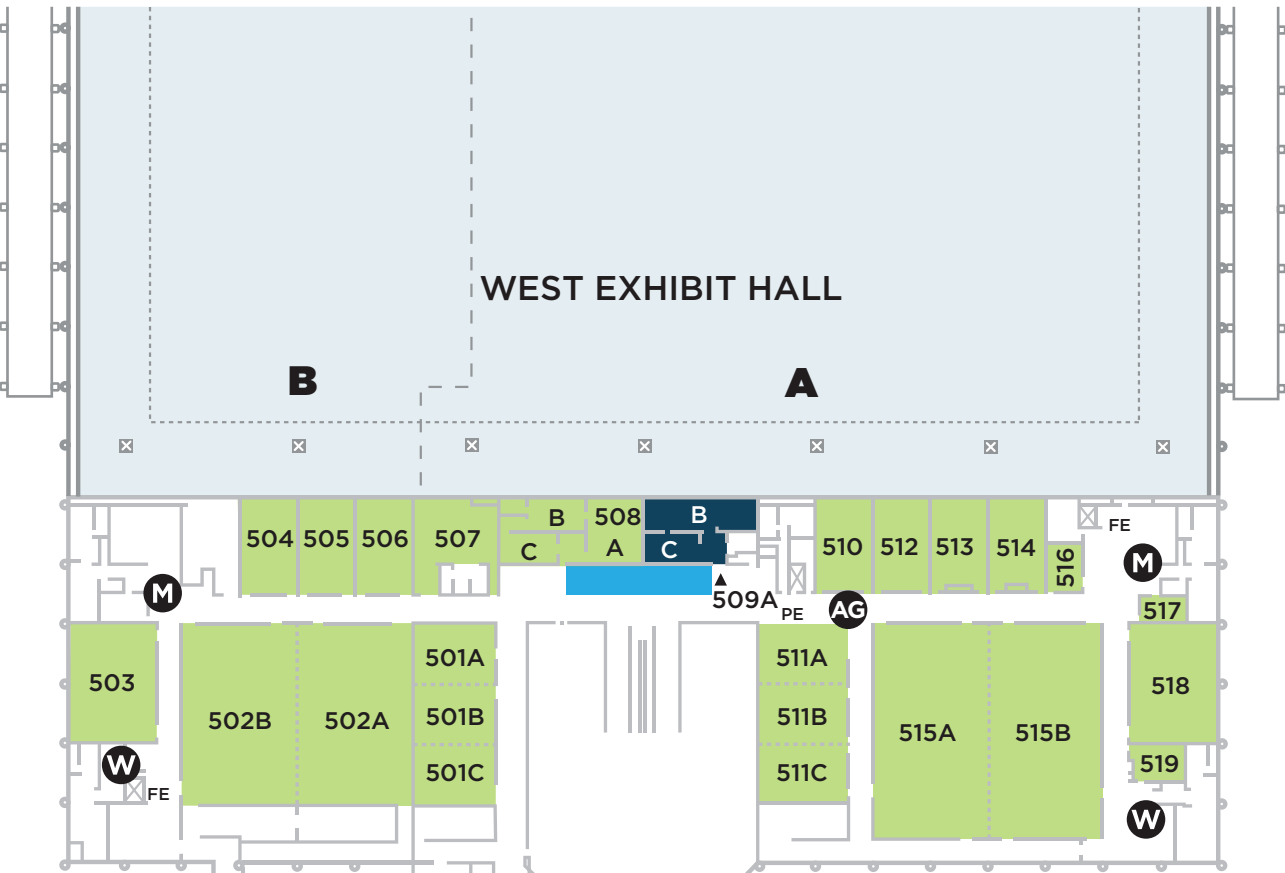
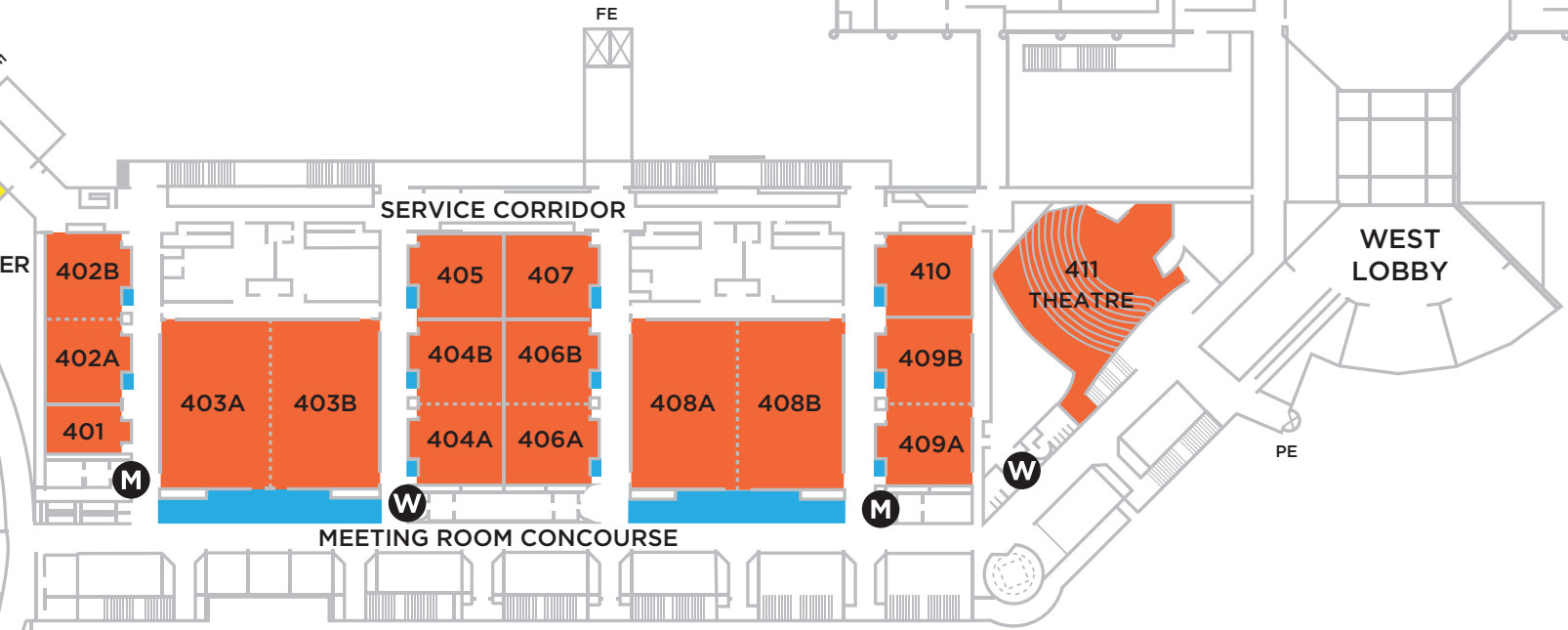
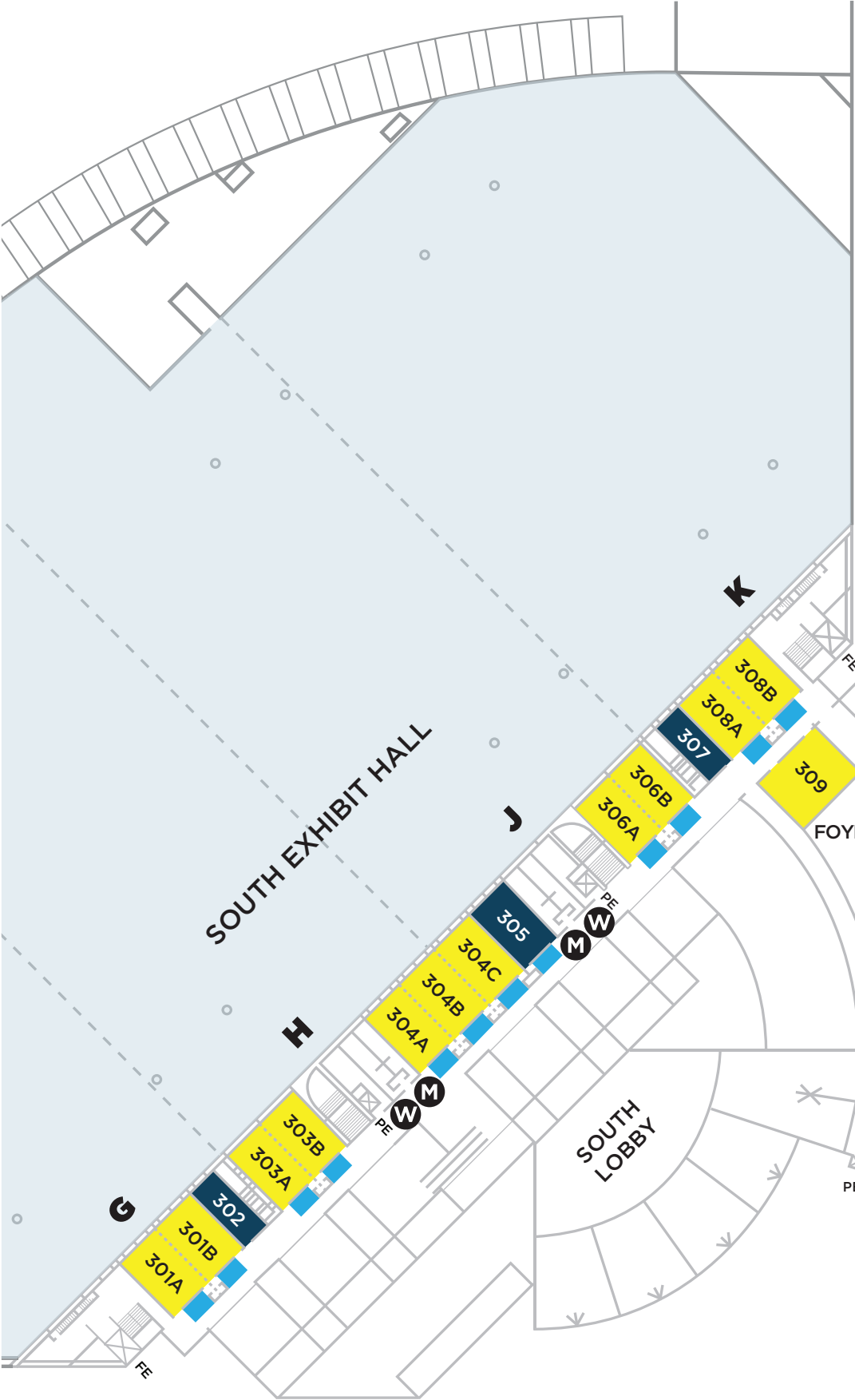

MEETING ROOM SERIES – LEVEL TWO

South Hall	DIMENSIONS	SQUARE FEET	CEILING HEIGHT	Maximum Capacity*		
				THEATRE	CLASSROOM ^(a)	BANQUET ^(b)
301 A	46 x 28	1,288	13'9"	100	50	50
301 B	46 x 29	1,334	13'9"	100	50	50
301 AB	46 x 58	2,668	13'9"	260	130	110
302 (Show Office)	46 x 19	874	13'9"			
303 A or B	46 x 28	1,288	13'9"	100	50	50
303 AB	46 x 57	2,622	13'9"	260	130	110
304 A, B, or C	46 x 29	1,334	13'9"	100	50	50
304 AB or BC	46 x 59	2,714	13'9"	260	130	110
304 ABC	46 x 89	4,094	13'9"	350	210	160
305 (Show Office or Meeting Room)	46 x 29	1,334	13'9"	100	50	50
306 A or B	46 x 28	1,288	13'9"	100	50	50
306 AB	46 x 57	2,622	13'9"	260	130	110
307 (Show Office)	46 x 19	874	13'9"			
308 A	46 x 29	1,334	13'9"	100	50	50
308 B	46 x 28	1,288	13'9"	100	50	50
308 AB	46 x 58	2,668	13'9"	260	130	110
309	35 x 57	1,995	13'9"	150	95	90
Concourse	DIMENSIONS	SQUARE FEET	CEILING HEIGHT	THEATRE	CLASSROOM ^(a)	BANQUET ^(b)
401	37 x 23	851	15'	50	40	30
402 A or B	37 x 41	1,517	20'	150	60	50
402 AB	37 x 82	3,034	20'	300	160	130
403 A	53 x 82	4,346	20'	500	280	200
403 B	50 x 82	4,100	20'	500	280	200
403 AB	103 x 82	8,446	20'	1,000	560	400
404 A or B	41 x 41	1,681	20'	150	70	60
404 AB	41 x 82	3,362	20'	300	160	150
405	41 x 40	1,640	15'	150	70	60
406 A or B	41 x 41	1,681	20'	150	70	60
406 AB	41 x 82	3,362	20'	300	160	150
407	41 x 40	1,640	15'	150	70	60
408 A or B	52 x 82	4,264	20'	500	280	200
408 AB	104 x 82	8,528	20'	1,000	560	400
409 A or B	41 x 41	1,681	20'	150	70	60
409 AB	41 x 82	3,362	20'	300	160	150
410	41 x 40	1,640	15'	150	70	60
411 (Theatre)		3,940	15'8"	299 fixed seating		

*Capacities listed above subject to change based on staging and audio-visual.
(a) Classroom set based on four (4) per 8'x18" table
(b) Banquet set based on ten (10) per 66" round table

West Hall	DIMENSIONS	SQUARE FEET	CEILING HEIGHT	Maximum Capacity*		
				THEATRE	CLASSROOM ^(a)	BANQUET ^(b)
501 A or B or C	41 x 28	1,148	13'6"	100	50	50
501 AB or BC	57 x 41	2,337	13'6"	200	140	100
501 ABC	87 x 40	3,480	13'6"	300	190	150
502 A or B	86 x 55	4,730	13'11"	550	280	200
502 AB	84 x 110	9,240	13'11"	1,125	560	550
503	57 x 42	2,394	13'4"	250	120	100
504	45 x 27	1,215	9'11"	100	50	50
505	45 x 27	1,215	9'11"	100	50	50
506	45 x 27	1,215	9'11"	100	50	50
507	41 x 31	1,213	9'11"	100	50	50
508 A (Lounge)	27 x 31	837	9'11"			
508 B or C (Boardroom)	15 x 28	420	9'11"			
509 A (Show Office)	12 x 15	180	9'11"			
509 B (Show Office)	55 x 16	880	9'11"			
509 C (Show Office)	27 x 15	405	9'11"	Existing Set: Boardroom For 8		
510	45 x 27	1,170	9'11"	100	50	50
511 A or B	42 x 28	1,176	13'6"	100	50	50
511 C	42 x 28	1,176	13'6"***	100	50	50
511 AB or BC	57 x 42	2,394	13'6"***	200	140	100
511 ABC	86 x 40	3,440	13'6"	300	190	150
512	45 x 27	1,215	9'11"	100	50	50
513	42 x 27	1,134	9'11"	100	50	50
514	42 x 27	1,134	9'11"	100	50	50
515 A or B	104 x 55	5,720	13'11"	650	360	240
515 AB	102 x 110	11,220	13'11"	1,300	720	650
516	23 x 14	322	9'11"	20	12	10
517	22 x 14	308	9'	20	12	10
518	57 x 42	2,394	13'4"	250	120	100
519	24 x 15	360	8'11"	20	12	10

*Capacities subject to change based on staging and audio-visual.
**10' soffit along divider wall tracks
(a) Classroom set based on four (4) per 8'x18" table
(b) Banquet set based on ten (10) per 66" round table



EXHIBIT AND SPECIAL EVENTS HALLS SPECIFICATIONS

SOUTH HALL

- **South Lobby**
 - 51,000 gross sq. ft.
 - Ceiling: 28’-53’
 - Pre-function Space: 8,072 sq. ft (shared)
 - Freight Door: 12’w x 8’h
 - Permanent First Aid Room
- **Hall G/Hall K**
 - Show office: (G) Room 302 (847 sq. ft.)
(K) Room 307 *847 sq. ft.)
 - Loading Docks: 10 each
 - Freight Door: 23’6”w x 37’h
 - Roll-Up Door: 16’1”w x 13’2”h
 - Interior Roll-Up Door: 9’7”w x 8’8”h
 - Pre-function Space: (G) 2,520 sq. ft.
(K) 7,601 sq. ft.
- **Hall H/Hall J**
 - Show Office: Room 305 (1,334 sq. ft.)
 - Freight Docks: 7 each
 - Freight Door: 16’1”w x 23’6”h
 - Pre-function Space: (H) 2,520 sq. ft.
(J) 3.032 sq. ft.

South Hall Specifications

- Floor Load: 350 lbs. per sq. ft.
- Floor boxes on 30’ centers equipped with
 - Electrical 208 volt, 3-phase up to 150 amps
 - Telecommunication connections
- Two (2) 1Gb CAT 5 connections to fiber node
- Potable and industrial water service and drain
- Compressed air and natural gas (specialized locations)*
- Lighting
 - 51’ candles
 - 230 watt energy efficient Lunera lamps
- Service available from overhead catwalks or floor ports
 - Electrical 208 or 480 volt, 3-phase up to 400 amps**
 - High Density Wi-Fi connectivity
 - Audio and video connections
- Sound System
 - Digital delay system

WEST HALL

- **West Lobby**
 - 33,925 gross sq. ft.
 - Ceiling: 9’-46’
 - Pre-function Space: 4,310 sq. ft (shared)
 - Freight Door: 24’10”w x 13’5”h
 - Permanent First Aid Room
- **Hall A**
 - Show office: Rooms 509ABC (1,465 sq. ft.)
 - Loading Docks: 4 each
 - Freight Door: 52’7”w x 25’h
24’w x 13’4”h (2)
 - Roll-Up Door: 5’10”w x 6’11”h (2)
 - Pre-function Space: 1,175 sq. ft.
- **Hall B**
 - Show Office: Room 101 (280 sq. ft.)
 - Freight Docks: 3 each
 - Freight Door: 24’ x 13’4”h
 - Roll-Up Door: 5’10½”w x 6’11”h
 - Pre-function Space: 686 sq. ft.

West Hall Specifications

- Floor Load: 300 lbs. per sq. ft.
- Floor ports on 10’ centers to provide service for
 - Electrical: 208 or 480 volt, 3-phase up to 400 amps
 - Telecommunication connections
- Potable and industrial water service and drain
- Compressed air and natural gas (specialized locations)*
- Lighting
 - 46’ candles
 - 230 watt energy efficient Lunera lamps
- Service available from overhead catwalks or floor ports
 - Electrical 208 or 480 volt, 3-phase up to 400 amps**
 - High Density Wi-Fi connectivity
 - Audio and video connections
- Sound System
 - Digital delay system

KENTIA HALL

- **Kentia Lobby**
 - 11,000 gross sq. ft.
 - Ceiling: 8’6”-21’3”
 - Pre-function Space: 1,000 sq. ft
- **Kentia Exhibit Hall**
 - Show Office: 1288 sq. ft.
 - Loading Docks: 6 each
 - Freight Door: 25’w x 15’h (4)
 - Roll-Up Doors: 7’w x 8’8”h (2)
 - Interior Roll-Up Doors: 16’7”w x 8’6”h (2)
 - Columns: 30” diameter on 30’ centers

Kentia Hall Specifications

- Floor Load: unlimited
- Column and wall boxes equipped with
 - Electrical: 208 volt , 3-phase electrical up to 150 amps
 - Telecommunication connections
- Two (2) 1Bg CAT 5 connections to fiber node
- Potable and industrial water service and drain (specialized locations)*
- Compressed air and natural gas (specialized locations)*
- Lighting
 - 53’ candles
 - 230 watt energy efficient Lunera lamps
- Services available from overhead or wall boxes
 - Electrical 480 volt, 3-phase up to 400 amps
 - High Density Wi-Fi connectivity
 - Audio and video connections
- Sound System
 - Audio and video connections
 - Digital delay system

*Compressed air and natural gas available at specialized locations only; consult your service provider for exact locations.
** Electrical in catwalks available upon special request.

EXHIBIT AND SPECIAL EVENTS HALLS SPECIFICATIONS

CONCOURSE HALL

- Concourse Hall EF (150/151/152/153)
- Carpeted Special Events/Exhibit Hall
- Show Office: Room 105 (245 sq. ft.)
- Loading Docks: 0*
- Freight Door: 9’7”w x 10’h
- Pre-function Space: 12,418 sq. ft.
- Divisible into 8 sections

Concourse Hall Specifications

- Floor Load: 100 lbs. per sq. ft.
- Wall boxes and floor boxes equipped with
 - Electrical: 208 or 480 volt, 3-phase up to 400 amps
 - Telecommunications connections
- Services available
 - High Denisty Wi-Fi connectivity
 - Audio and video connections
- Sound System
 - Distributed speaker system
- Lighting system
 - 50’ candles
 - 32 watt NaturaLED box lights and 17 watt NaturaLED tube lights

*Loading area available without raised docks

PETREE HALL

- Petree Hall CD
- Carpeted Special Events/Exhibit Hall
- Show Office: Room 103 (270 sq. ft.)
- Loading Docks: 0*
- Freight Door: 11’3”w x 13’9”h
9’8”w x 8’11”h (2)
- Pre-function Space: 196 sq. ft.
- Divisible into 2 sections

Petree Hall Specifications

- Floor Load: 100 lbs. per sq. ft.
- Wall boxes equipped with
 - Electrical: 208 or 480 volt, 3-phase up to 400 amps
 - Telecommunications connections
- Floor Ports (specialized locations)* provide access to
 - Potable and industrial water service and drain
 - Compressed air
 - Natural gas
- Services Available
 - High Density Wi-Fi connectivity
 - Audio and video connections
- Sound system
 - Distributed speaker system
- Lighting system
 - 43’ candles

*Loading area available without raised docks

MEETING ROOM SPECIFICATIONS (300, 400, 500 SERIES), LEVEL TWO

Meeting Rooms

- Carpeted rooms
- Pre-function space: varies per room
- Floor load: 100 lbs per sq. ft

Electrical

- 120 volt, 20 amp outlets
- 208 volt, 3-phose electrical service

Lighting System

- Pre-programmed settings
- 35 watt energy efficient LG lamps in 300-400 meeting rooms
- Dimming capability

Network

- Two (2) 100/1000 MB, CAT 5 connections to fiber node
- Facility-wide fiber optic cabling backbone

Audio

- Permanently installed sound system
- Audio distribution
 - Overhead speakers
 - Can be patched to other rooms and halls
 - Custom installation available
 - House sound exclusive through in-house AV operator

Video

- Permanently installed video systems
- Video distribution
 - Can be patched to most locations within facility

Telecommunications

- Wireless internet is available throughout the building
- Single-line and multi-line telephones
- Various telephone programming functions (call forwarding, hunt groups, etc.)
- Dedicated modem and ISDN lines





**DIGITAL
DIAGRAM
BROCHURE**



**EVENT
PLANNING
GUIDE**

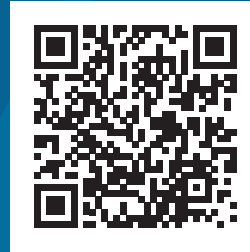

**AUTHORIZED
CONTRACTORS**

Los Angeles

**CONVENTION
CENTER**

Managed By **ASM**
GLOBAL



1201 South Figueroa Street
Los Angeles, CA 90015

phone: (213) 741-1151

www.lacclink.com